

MILKING COW PUSHER
WITH A MANURE SCRAPER

MODEL: PD-23S

PRODUCT PRESENTATION

farmtec[®]

MILKING COW PUSHER, MODEL: PD-23S

- with a manure scraper

MANUFACTURER:

FARMTEC a.s.



Content

Content 2

EQUIPMENT CHARACTERISTICS..... 3

BASIC TECHNICAL DATA 4

EASILY OPERATED 4

PHOTOS FROM THE IMPLEMENTATION..... 6

INSTALLATION OPTIONS DEPENDING ON FLOOR SURFACE 7

EQUIPMENT CHARACTERISTICS

The cow pusher with manure scraping function is a metal structure separating a group of cows in front of the milking parlour (holding pen). The structure activates behind the last cow in the group and gently pushes the entire group towards the milking parlour. An electric motor ensures the cow pusher's movement along the channel. After the last cow in the group enters the milking parlour, the staff raise the pusher by pressing the corresponding button on the control panel. The pusher structure passes over the holding pen in a raised position, over the heads of the next group of animals waiting to enter the milking parlour, and moves down behind them.

The bottom structure of the cow pusher with manure scraper is additionally equipped with blades. When moving backwards away from the milking parlour and in the absence of animals and staff, the pusher can clean the floor from manure using the blades, by pushing it into the grid slots or into the manure channels.

The cow pusher is controlled by the operator or milking operator, directly from the milking parlour. The pusher's presence significantly speeds-up the process of pushing animals into the milking parlour, reduces the animals' stress associated with the staff activities, and saves on labour force. Among other things, the cow pusher with a manure scraping function helps significantly to reduce water consumption when cleaning the holding pen.

If the cow pusher encounters an obstacle (animal or rubber stop at the end of the channel), the electric motor switches off based on the limit switch signal. After removing the obstacle (the animal leaves) or by manually switching the direction of movement (the pusher reaches the stop), the pusher continues to move in the specified direction.

The cow pusher is equipped with an electric buzzer signalling its movement towards the milking parlour.

BASIC TECHNICAL DATA

- Standard range of pusher axial width dimensions:
6,200 – 11,800 mm
- **Maximum channel length: 25,000 mm**
- Maximum alley width: 1,200 mm (alley for cows leaving the milking parlour)
- Height from the holding pen floor: 3,090 mm
- Maximum slope of the holding pen floor: 4°
- Holding pen gate height: 1,960 mm
- Channel height: 2,000 mm
- Total weight up to: 1,100 kg
- Travel speed: 4 m/min.
- Gate lifting speed: 8 s

EASILY OPERATED

The D2 control panel is located on both sides of the milking parlour entrance. The use of this button only allows control of the cow pusher's movement towards the milking parlour. The pusher starts moving to the milking parlour within a period of time specified on the pusher's distribution device by pressing the green button. By pressing the red button, the pusher can be stopped at any time.

The P5 control panel moves and lifts the cow pusher gate. It is located at the holding pen's entrance, in an area that is inaccessible to cows. The buttons control the electric motors, which ensure comfortable control of the pusher's movement and lift the pusher's gate.

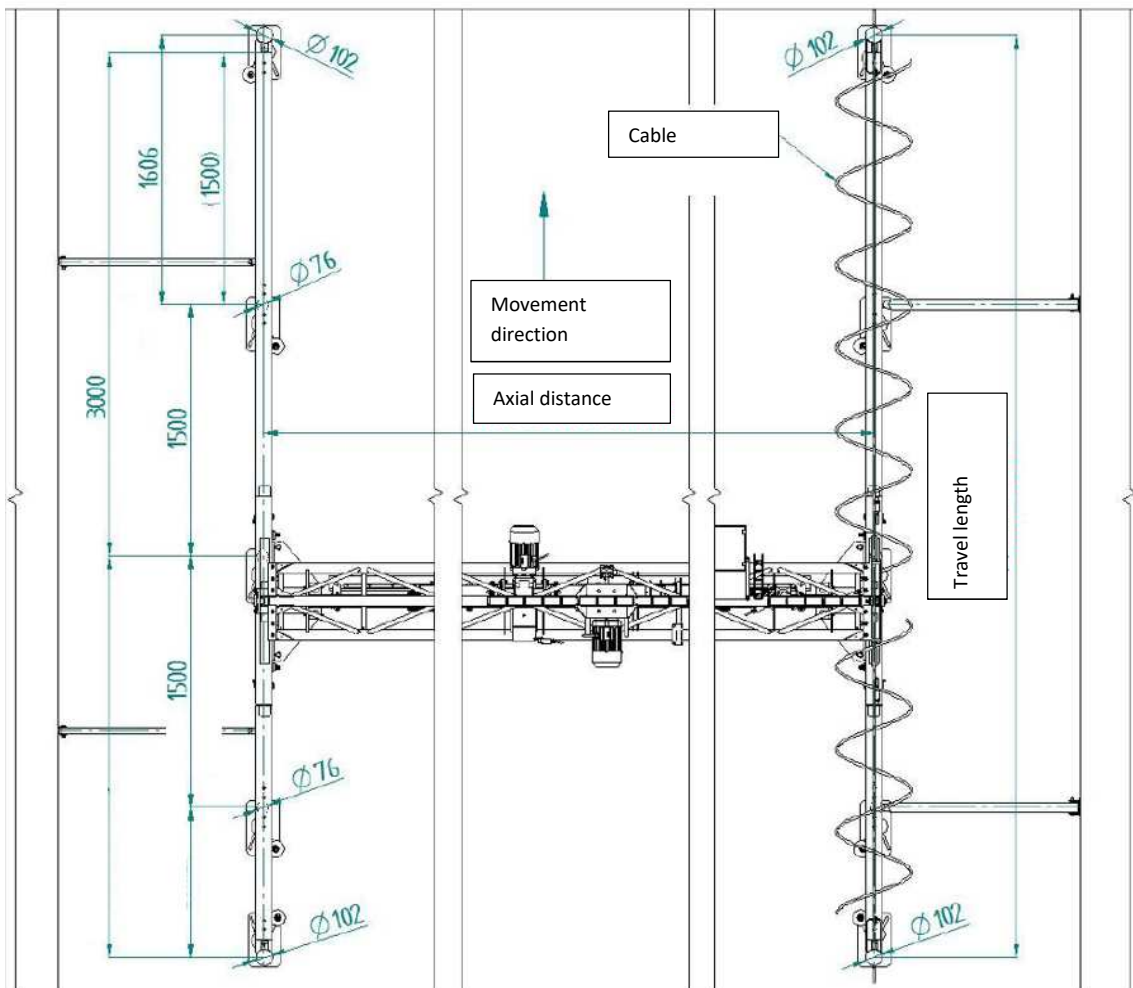
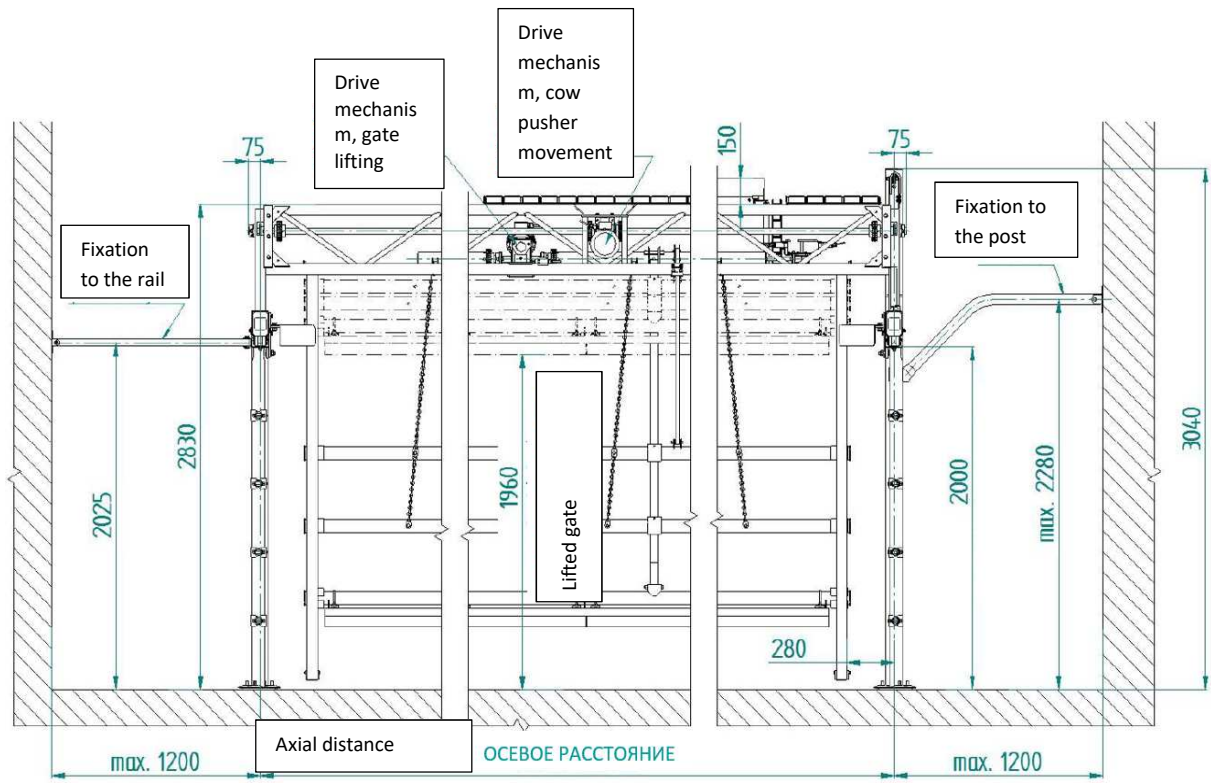

PHOTOS FROM THE IMPLEMENTATION



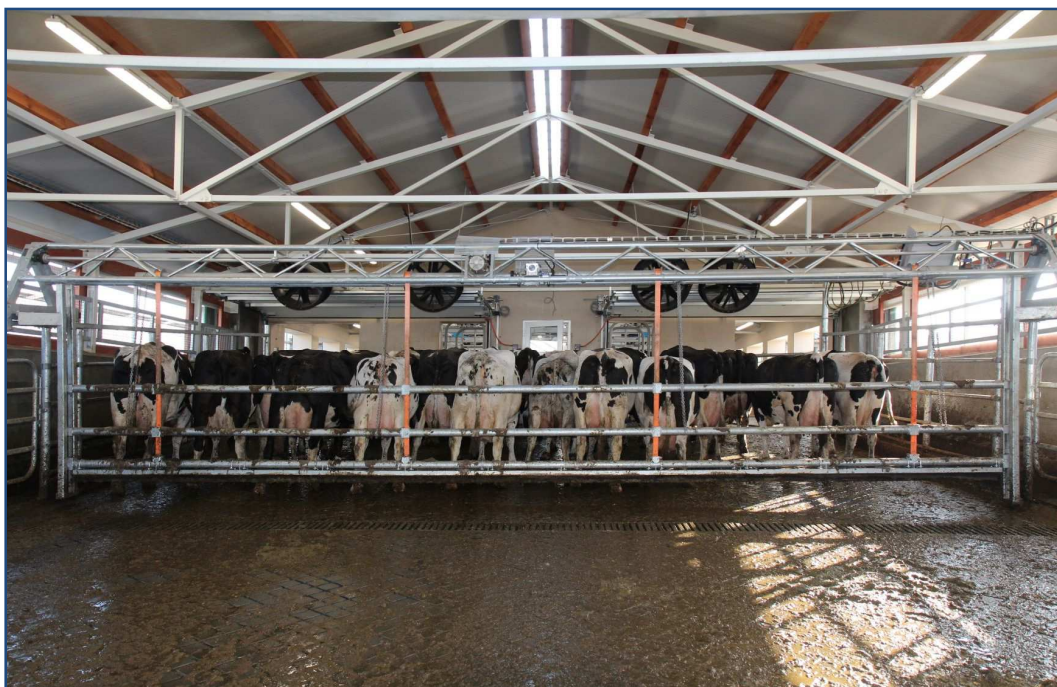

INSTALLATION OPTIONS DEPENDING ON FLOOR SURFACE

PD-23S PUSHER WITH A MANURE SCRAPER AND INSTALLATION INTO CONCRETE FLOOR

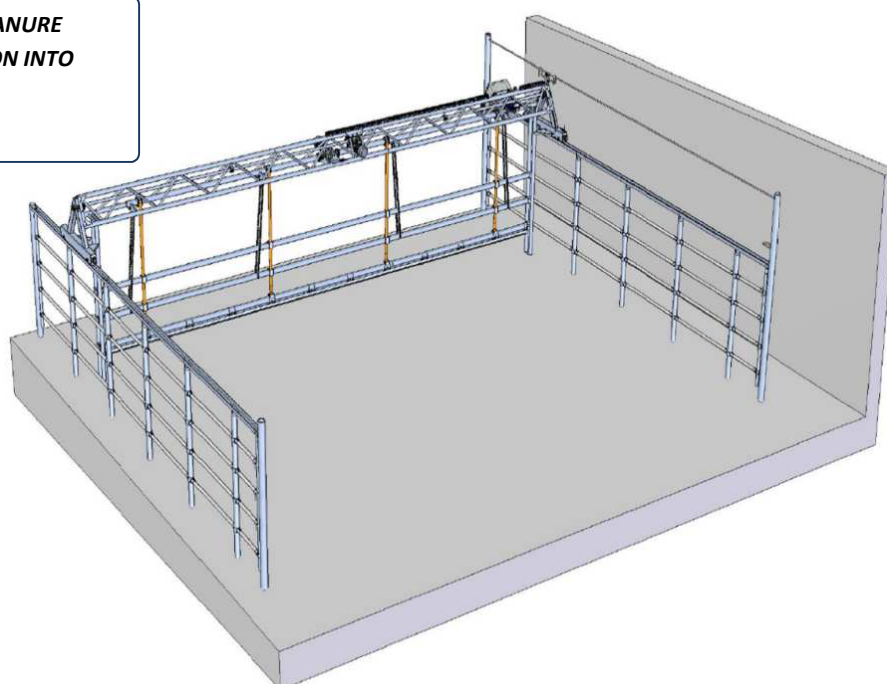

**PD-23SA PUSHER WITH A MANURE
SCRAPER AND INSTALLATION ONTO
CONCRETE FLOOR**

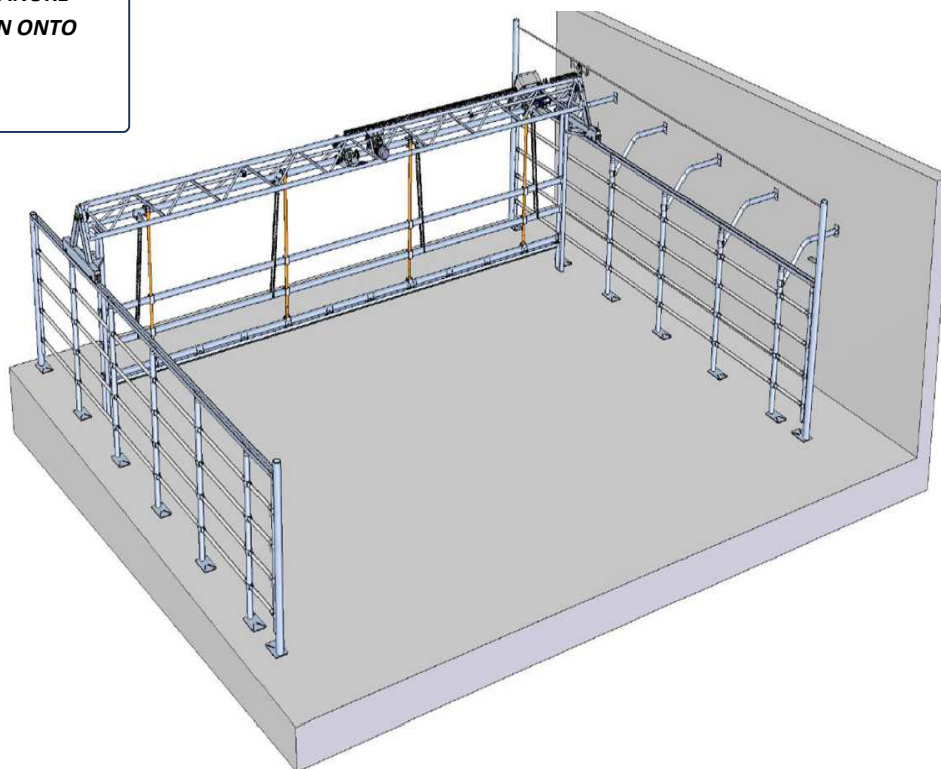

**PD-23S PUSHER WITH A MANURE
SCRAPER AND INSTALLATION ON A
CONCRETE GRID**

